

LED Resistor- assembly instruction

Motstandsboks LED lys 12V
 Art. 13282

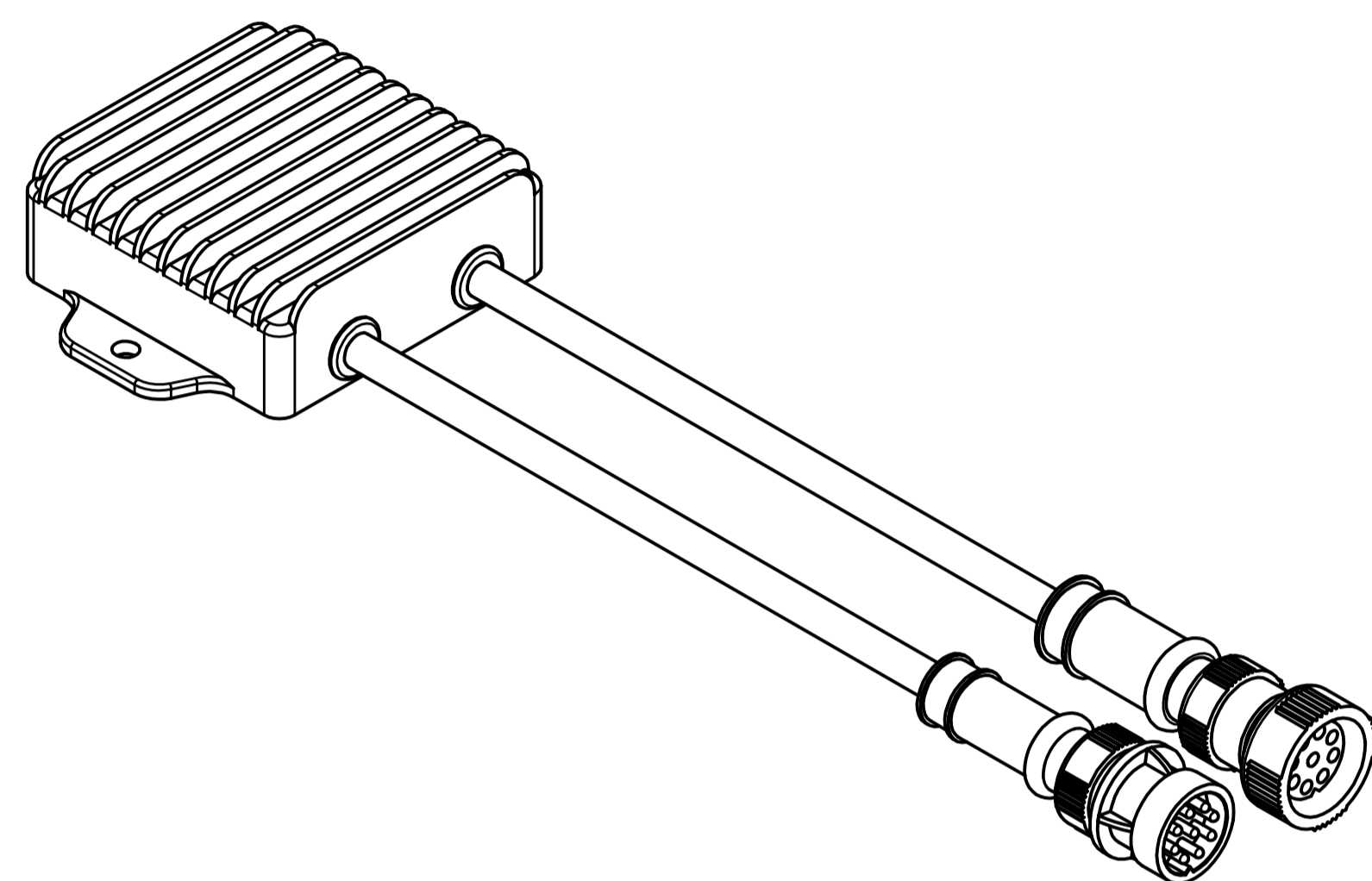

For veiledning se:
bkhengeren.no/montering



REVISION HISTORY			
REV	DESCRIPTION	DATE	AUTHOR
A		26.09.2019	MM

1.

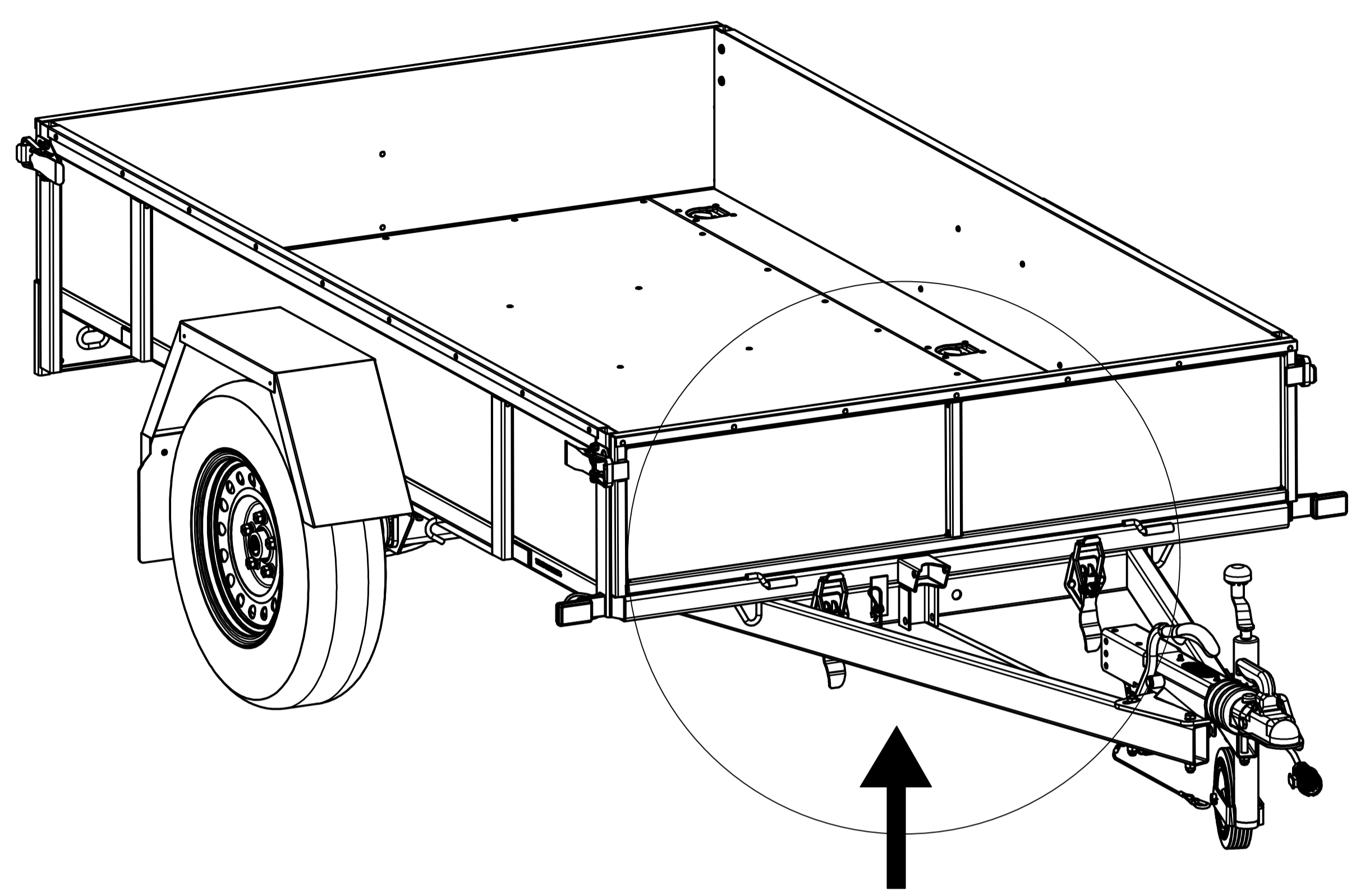

2.

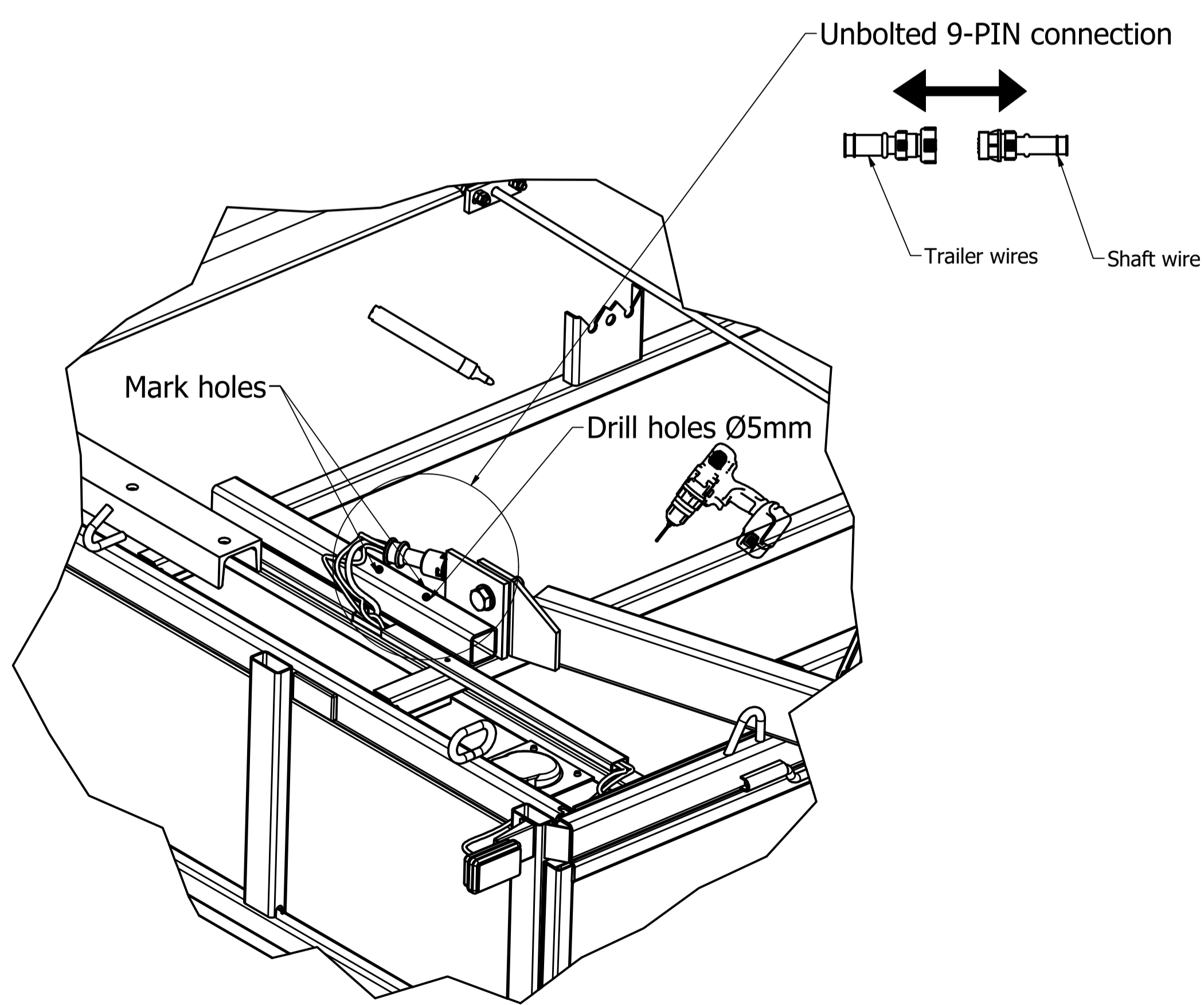

3.

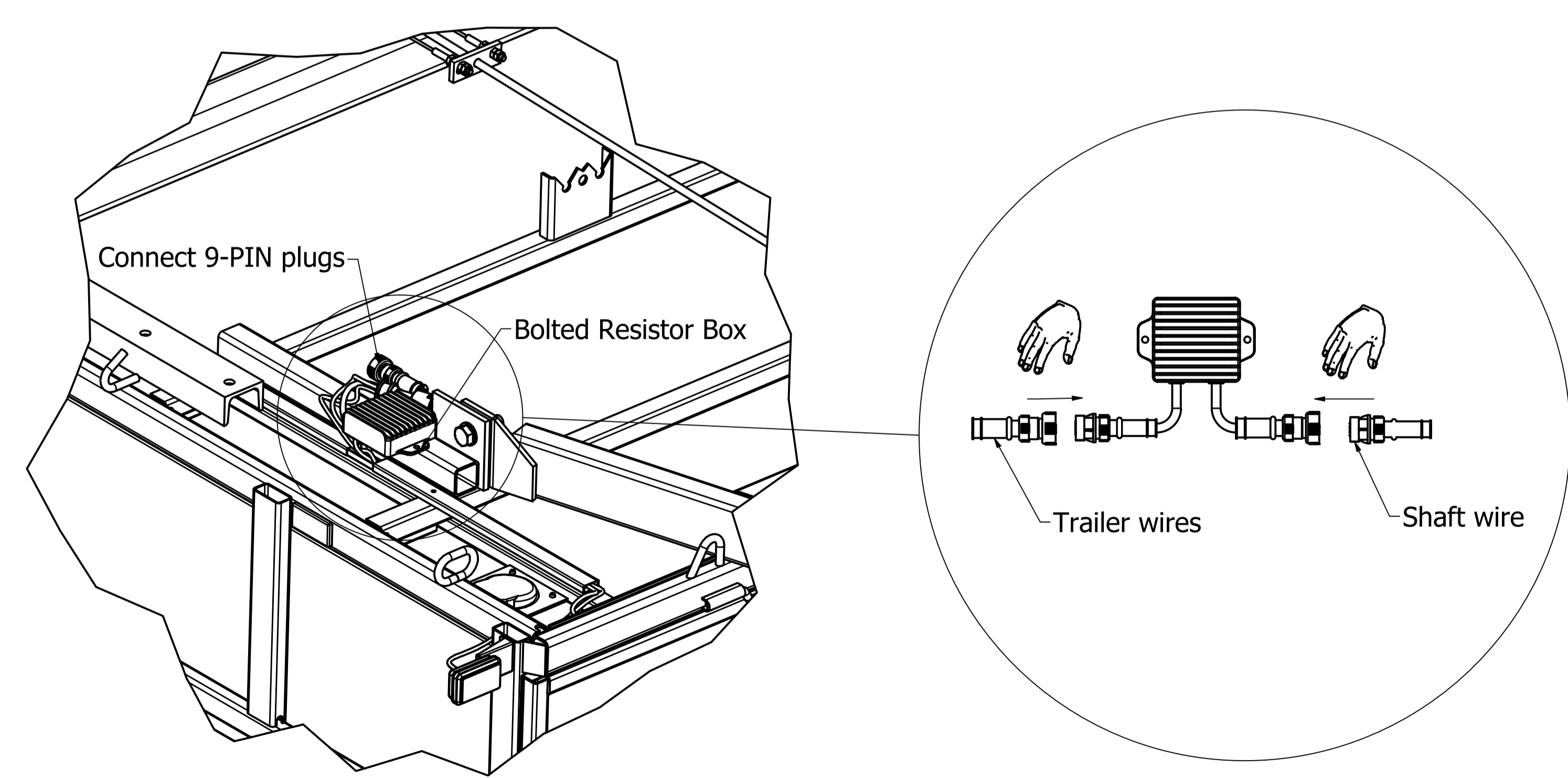

GENERAL NOTE:
 - Tolerances according to ISO 2768 - medium if nothing else specified.
 - Hot Dip Galvanization according to ISO 1461
 - Electro Galvanization according to ISO 1461
 - Power Coating according to ISO 2360

Created By: MM	Creation Date: 21.09.2019	Total Nos: N/A	Format: A1	Scale: 0,12 : 1	Sheet of Sheets: 1 / 2
		Title: Assembly instruction- Utility trailer Utility Trailers			
Part Number (Swilag): NK	Drawing Number: IN109917		Rev: A		

1.

V-shaft version

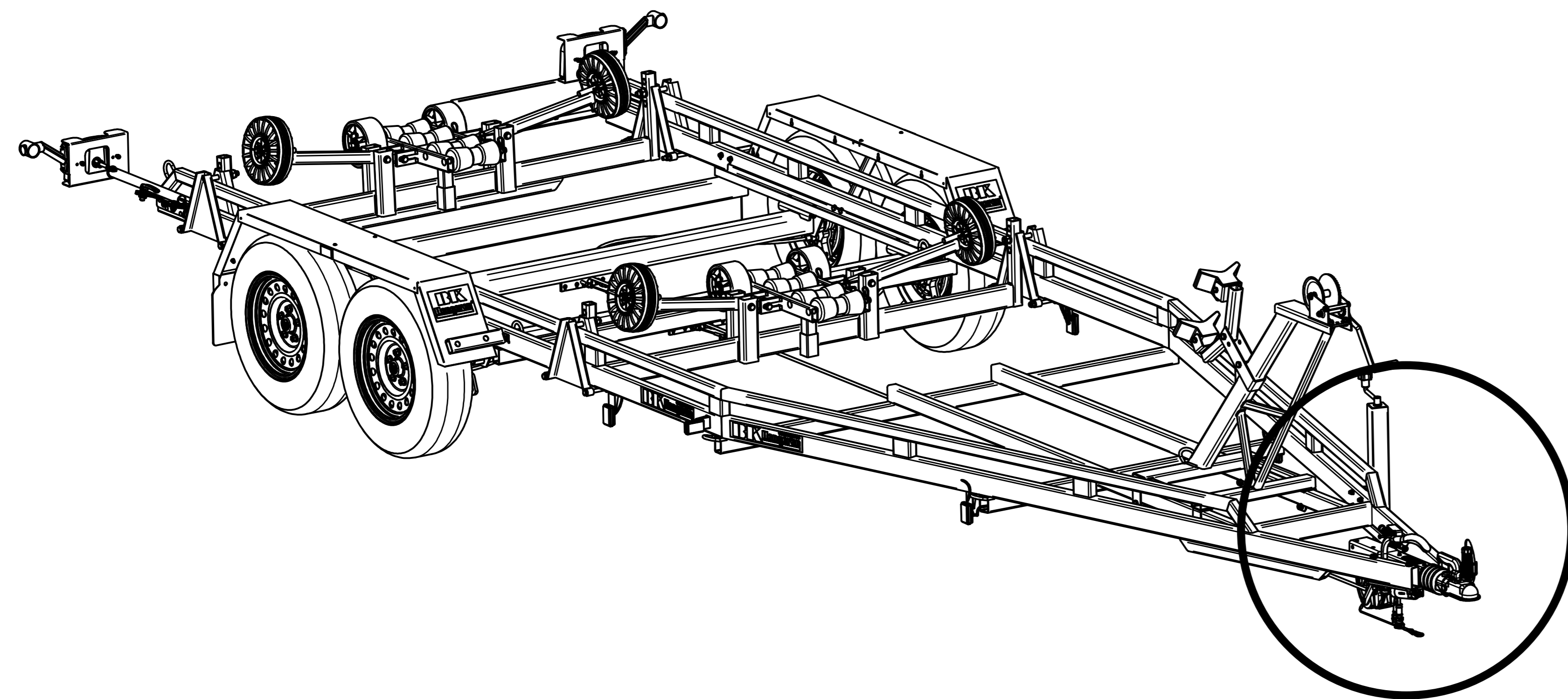

1.

Tube-shaft version

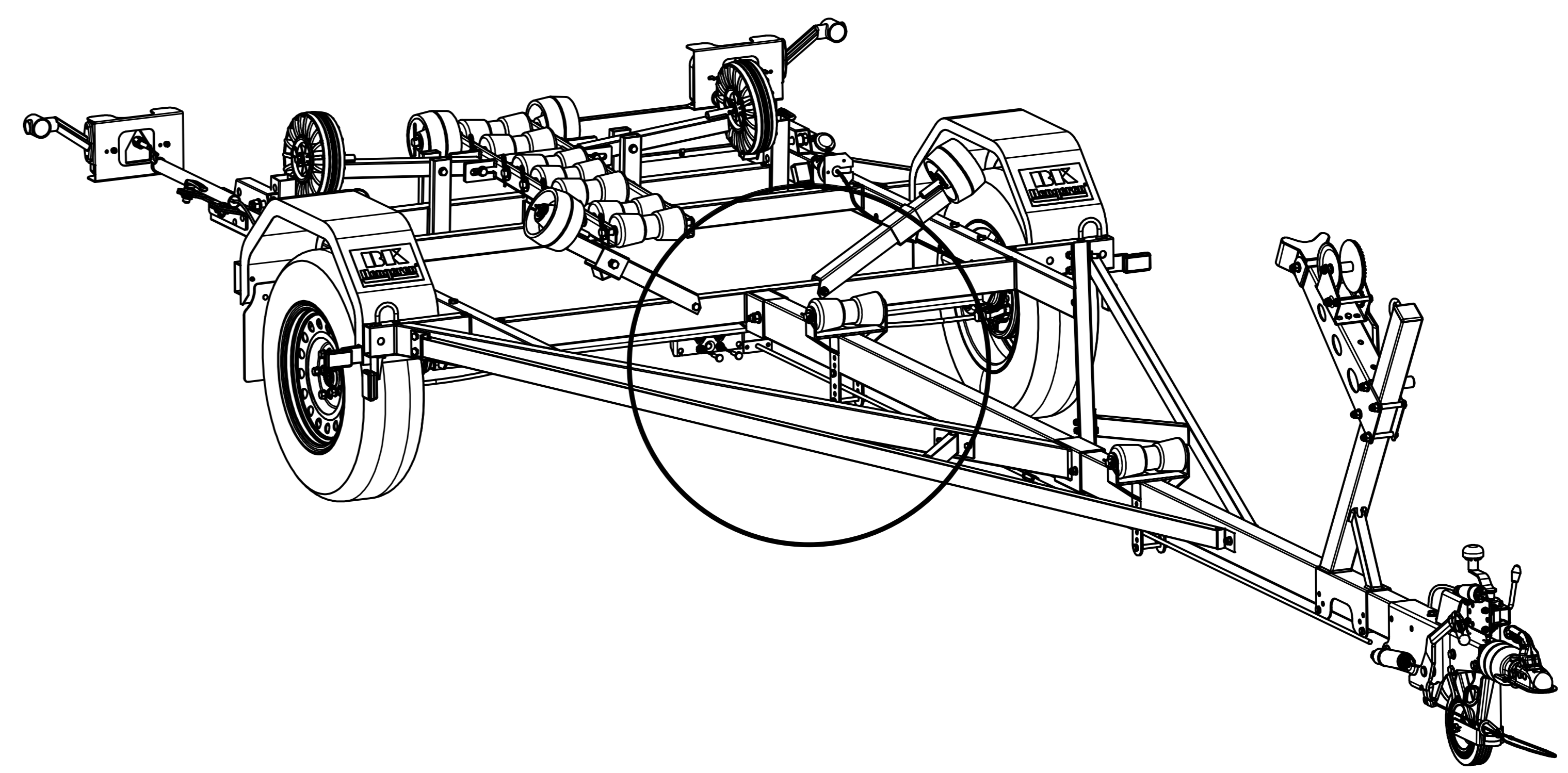

2.

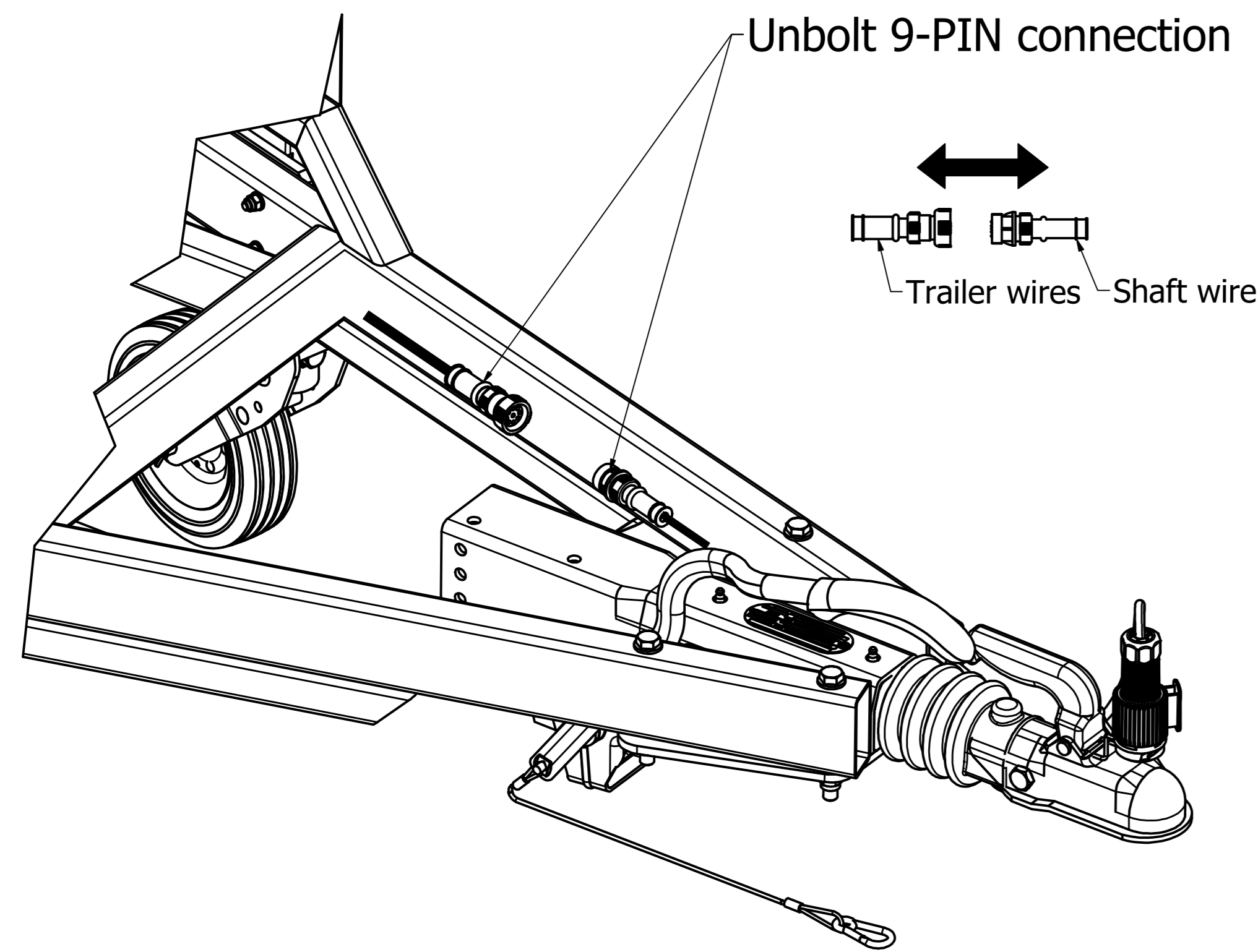

3.

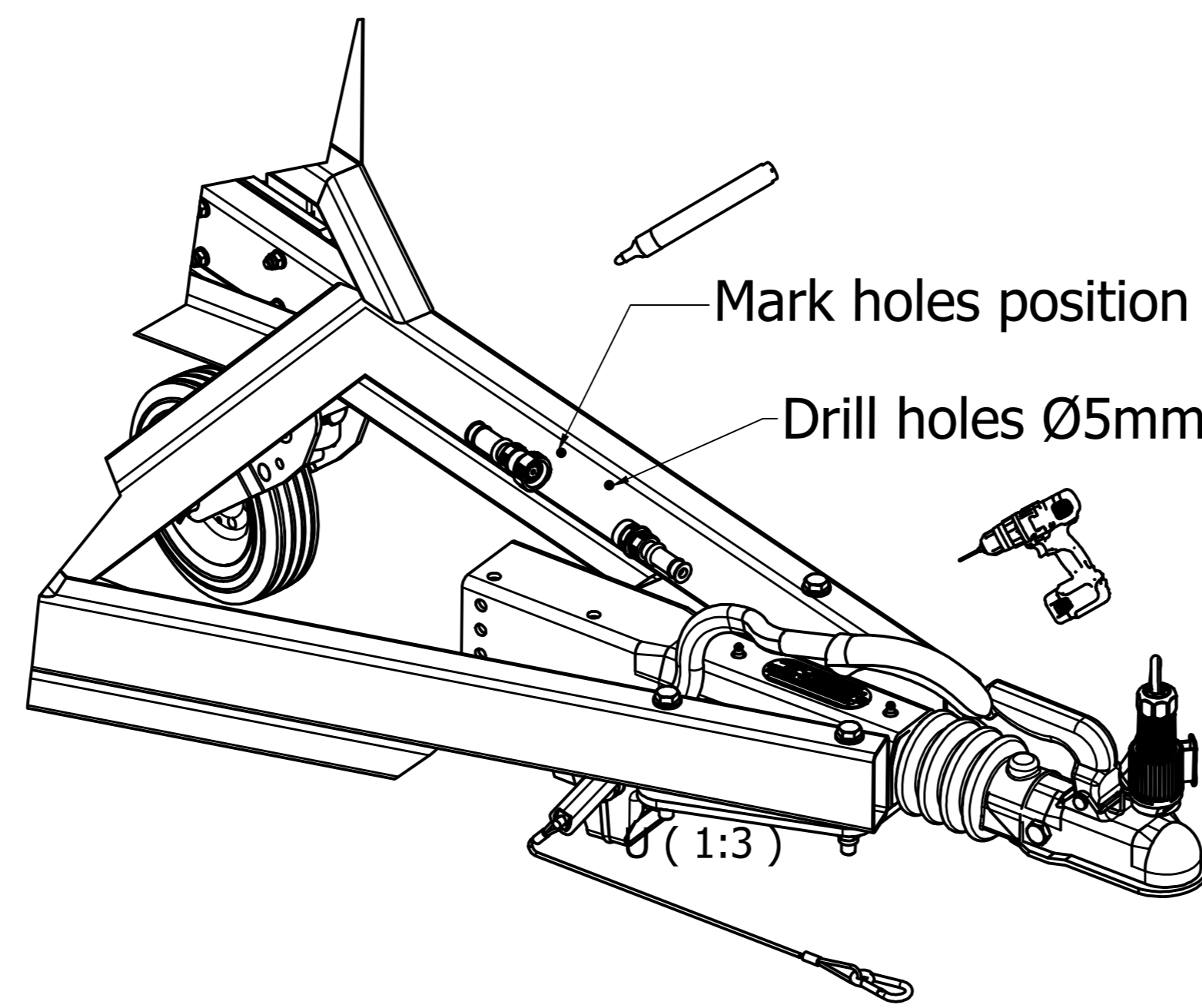

2.

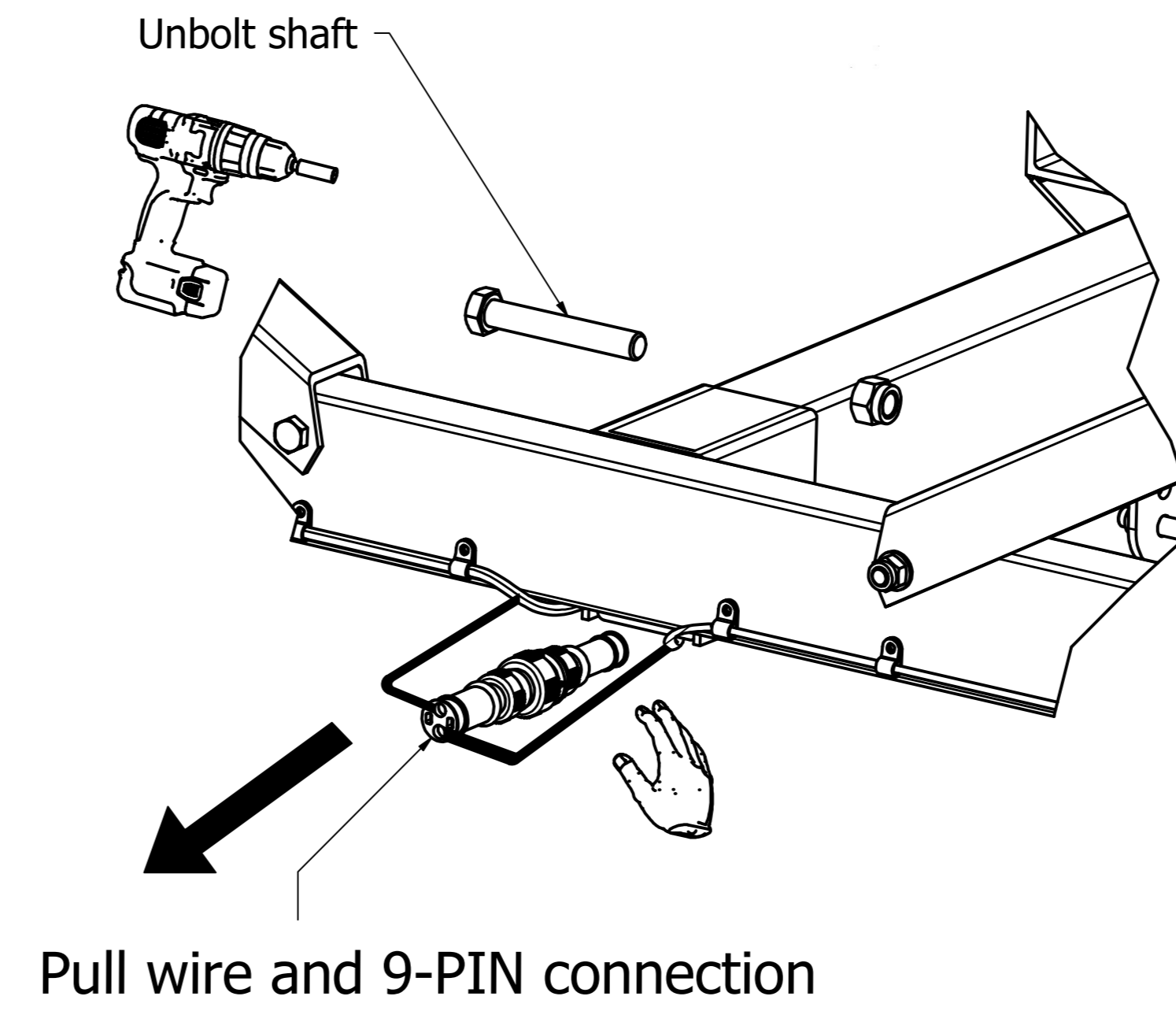

3.

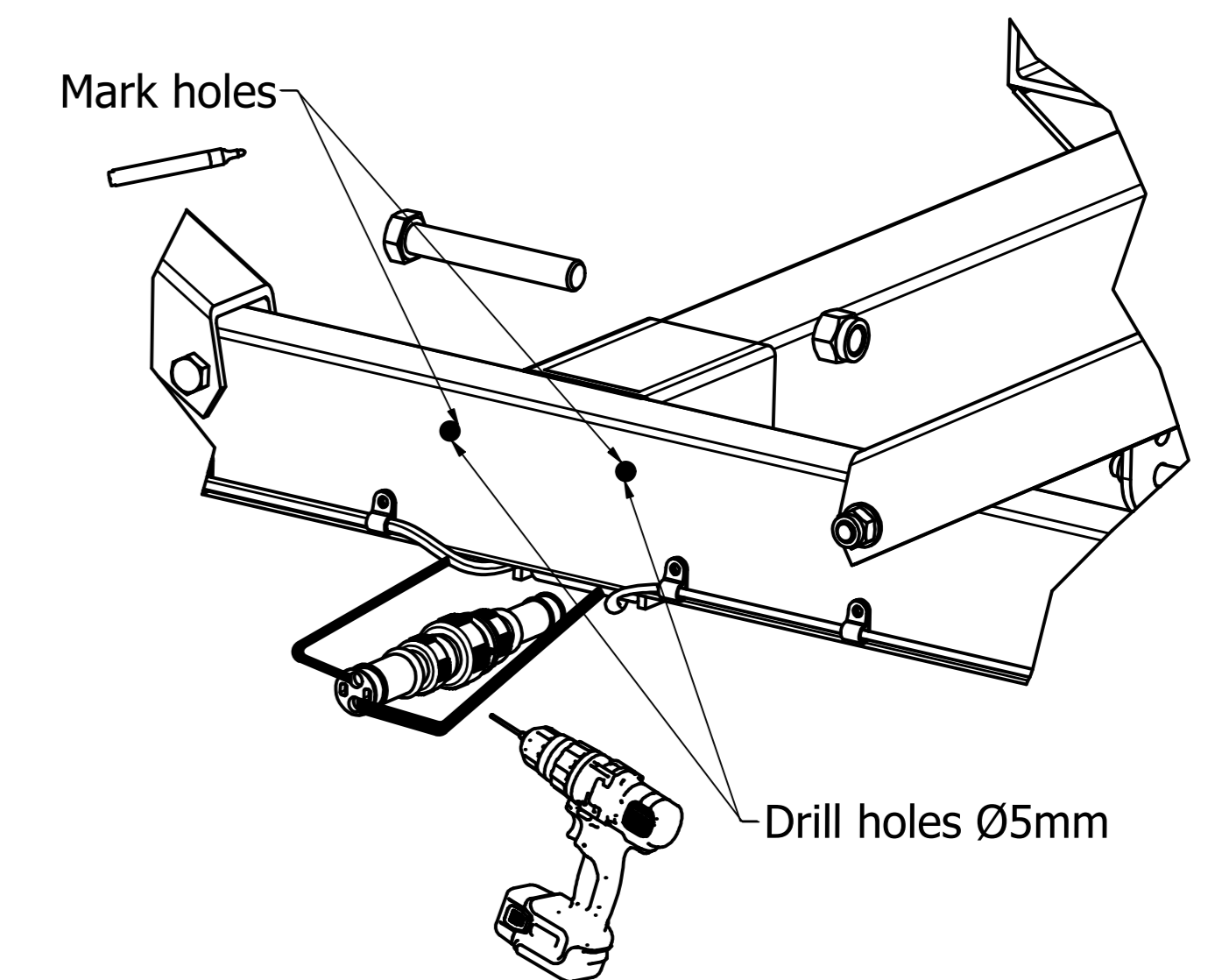

4.

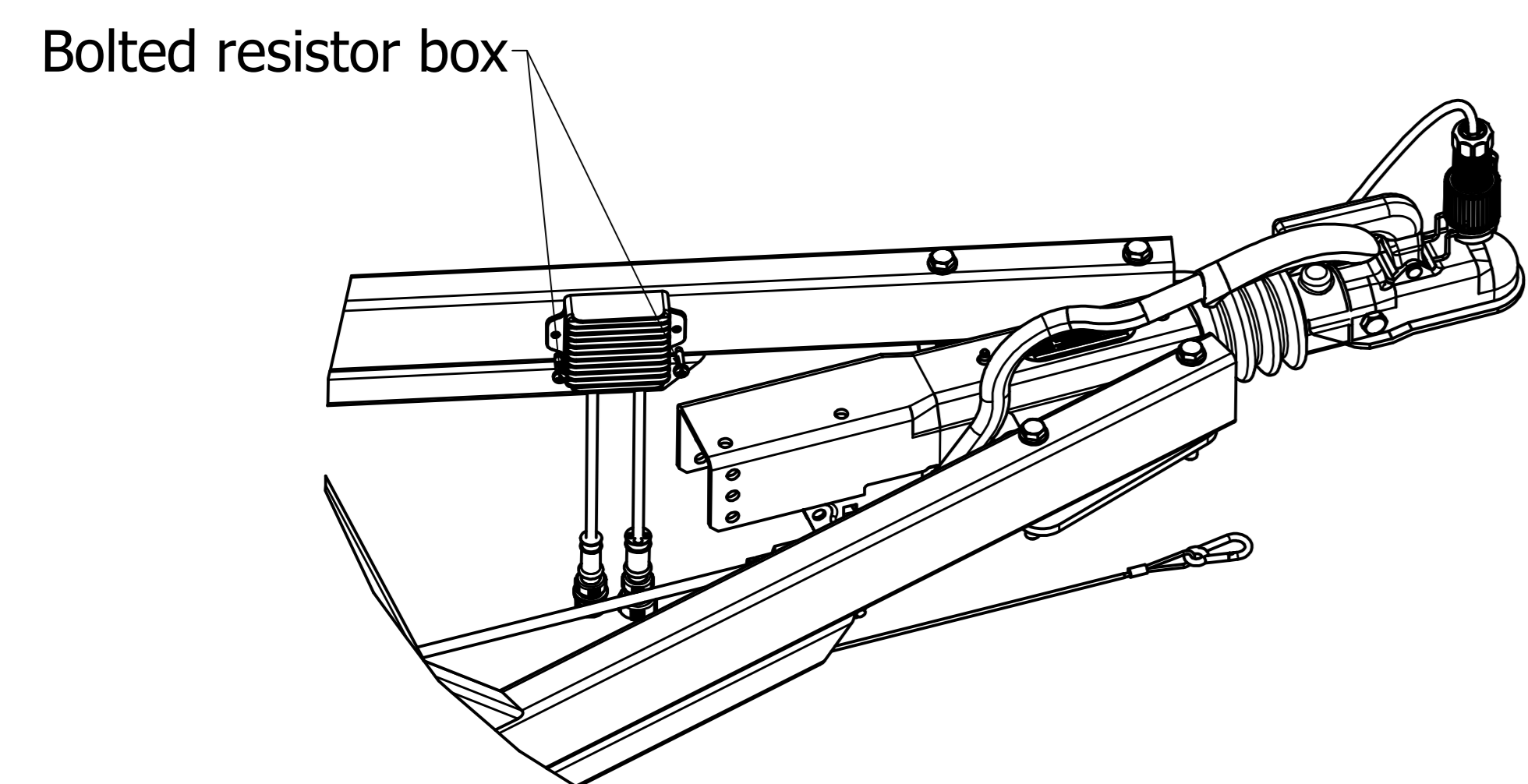

5.

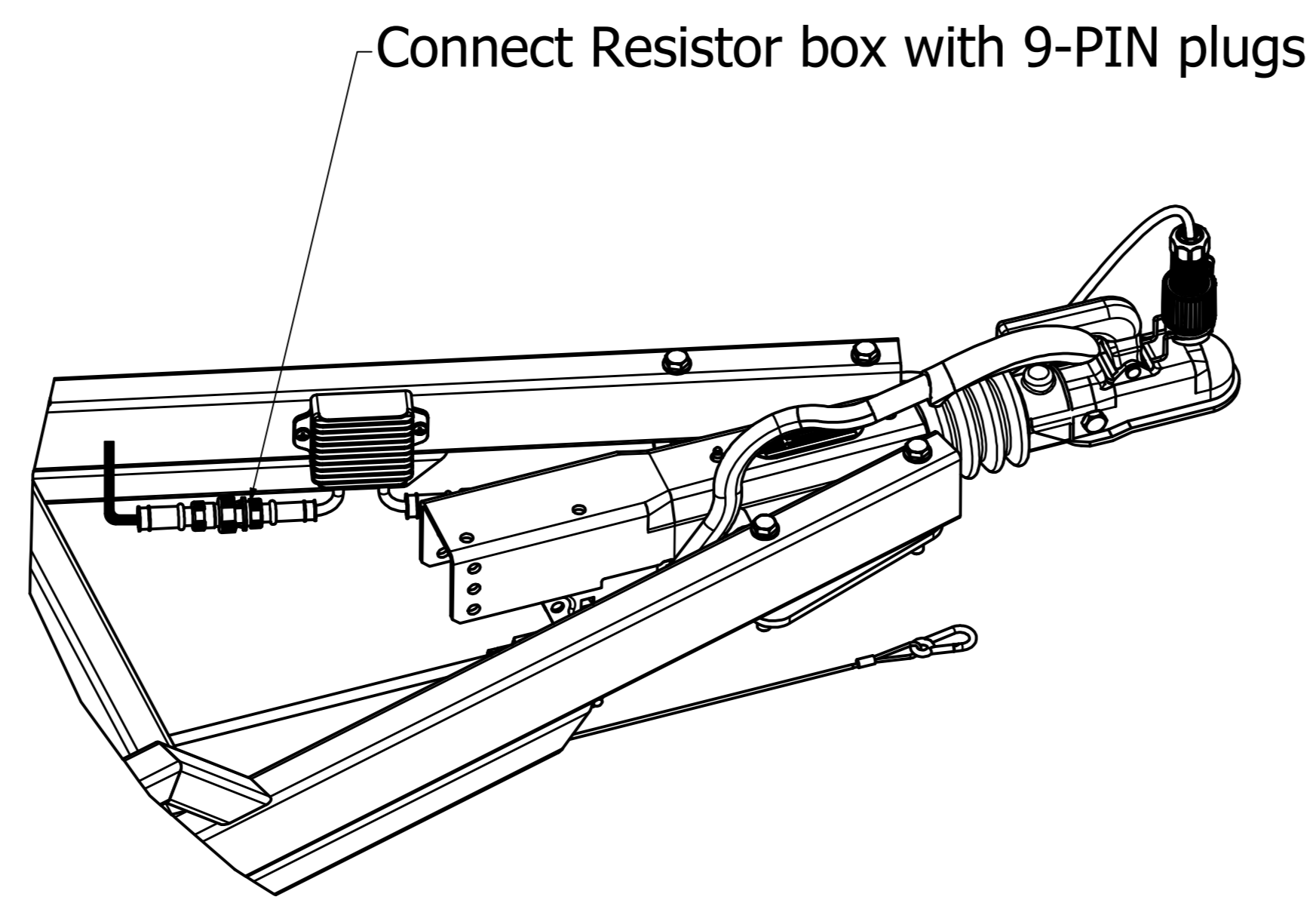

4.

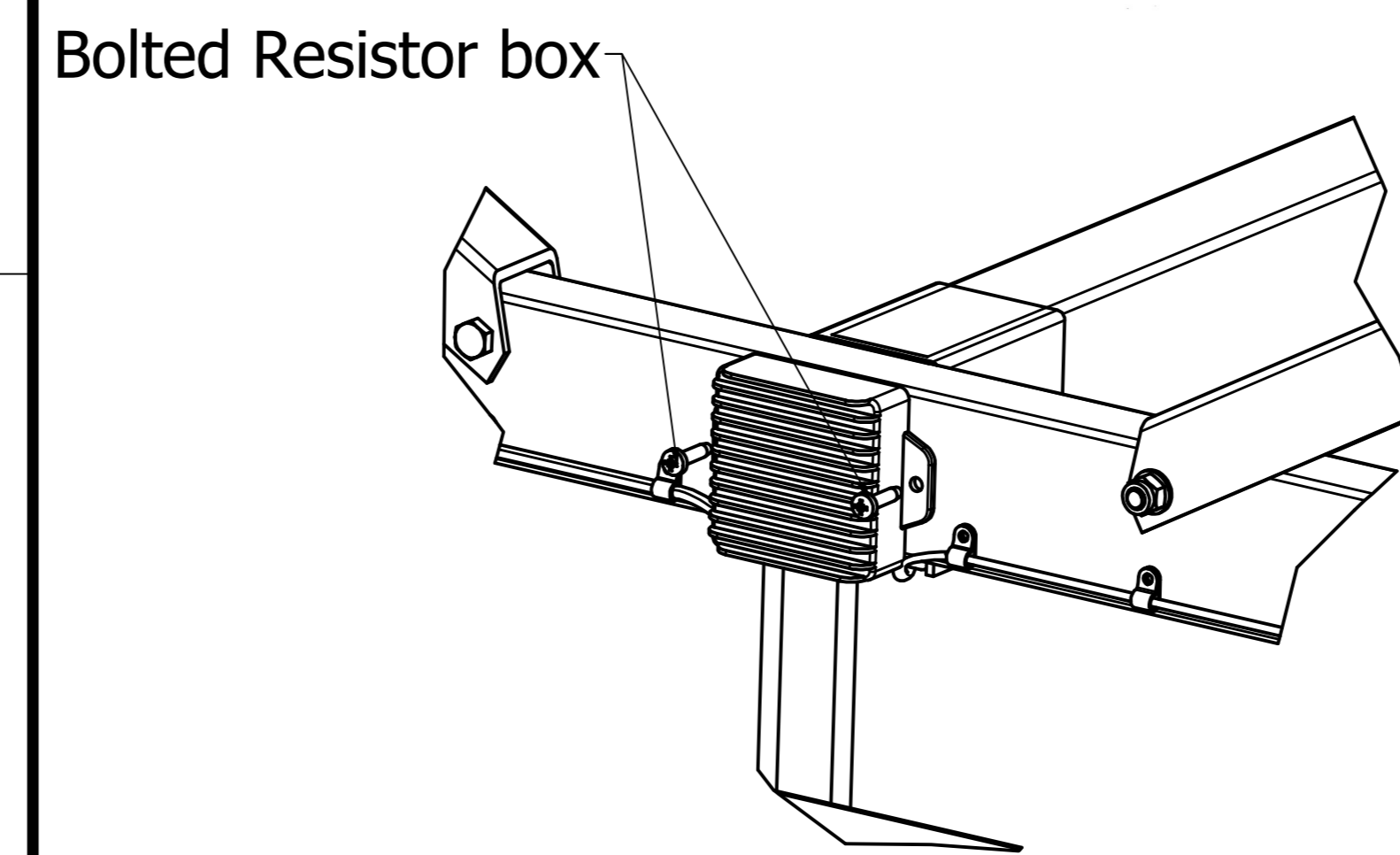

5.

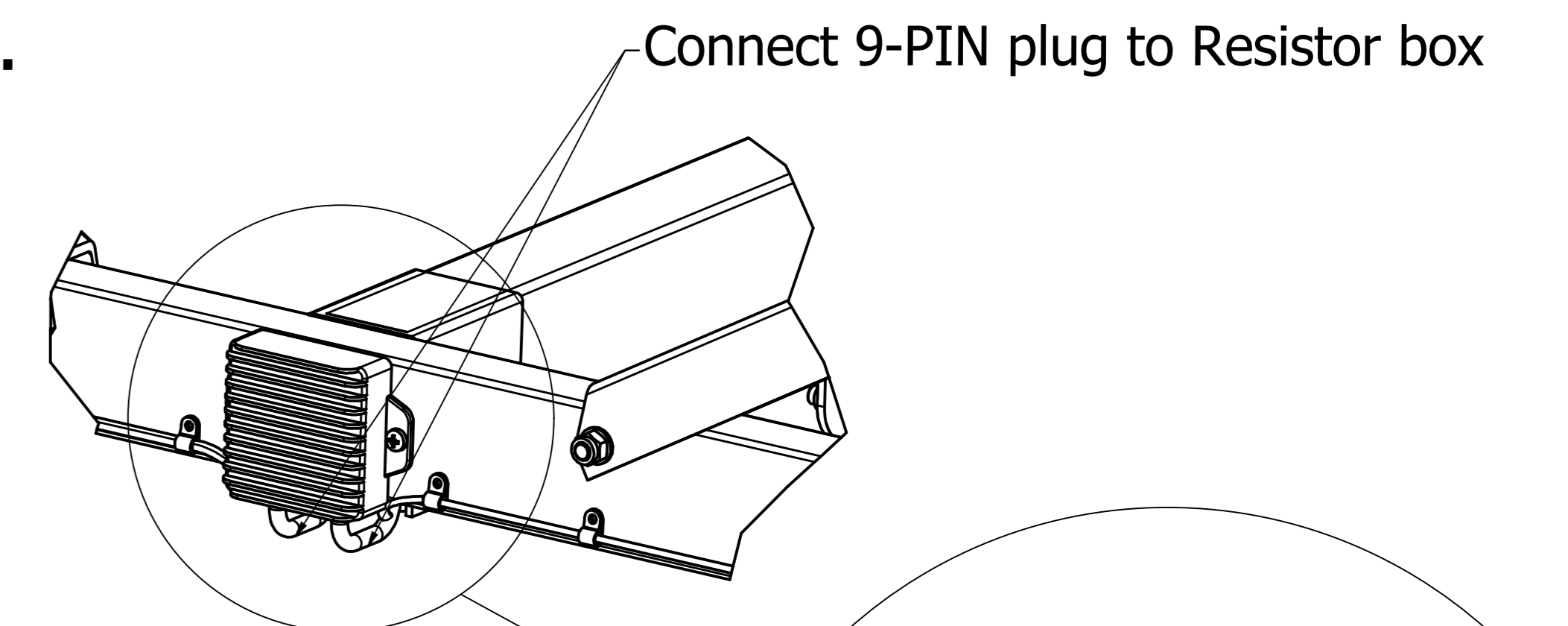

6.

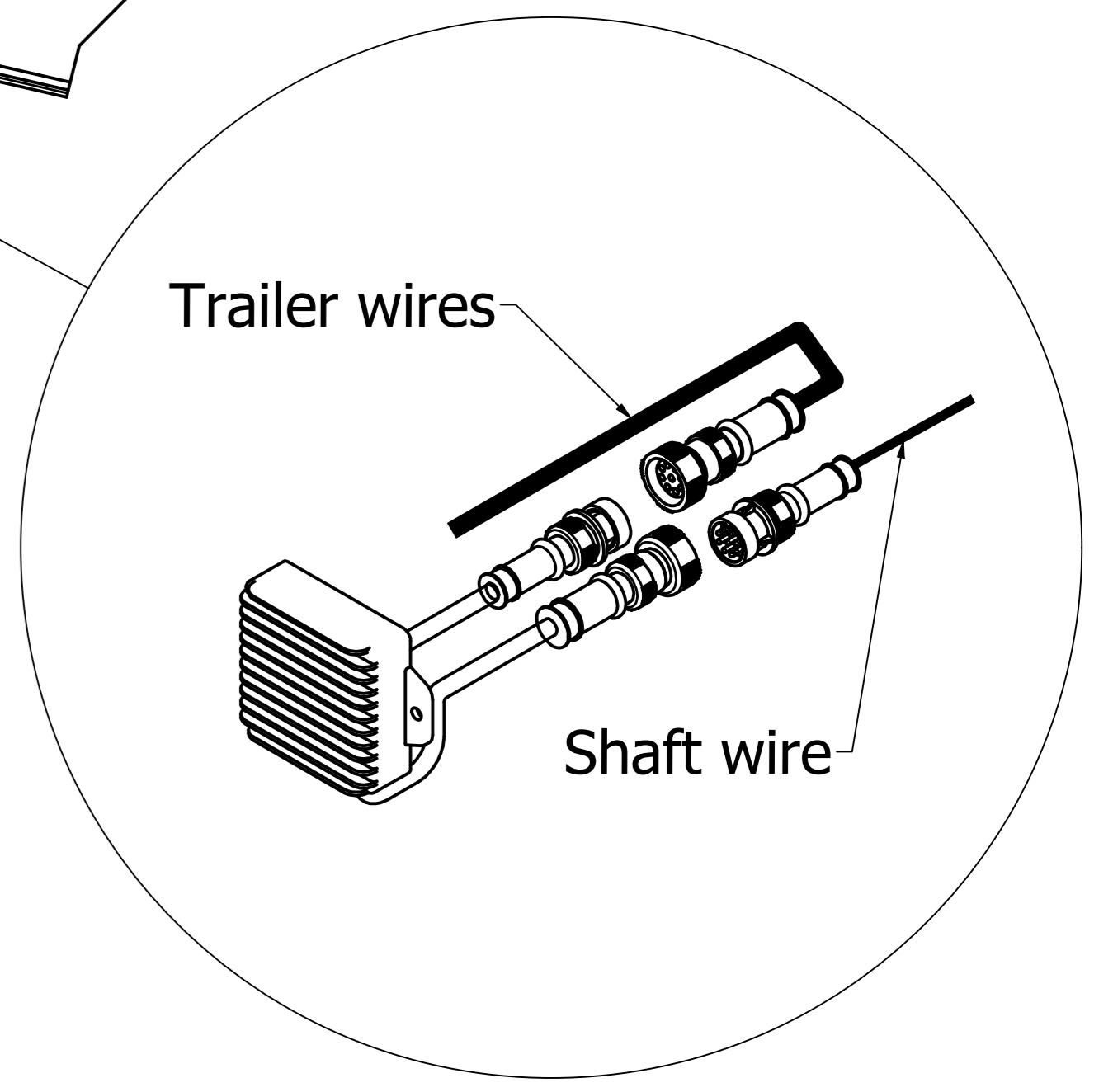
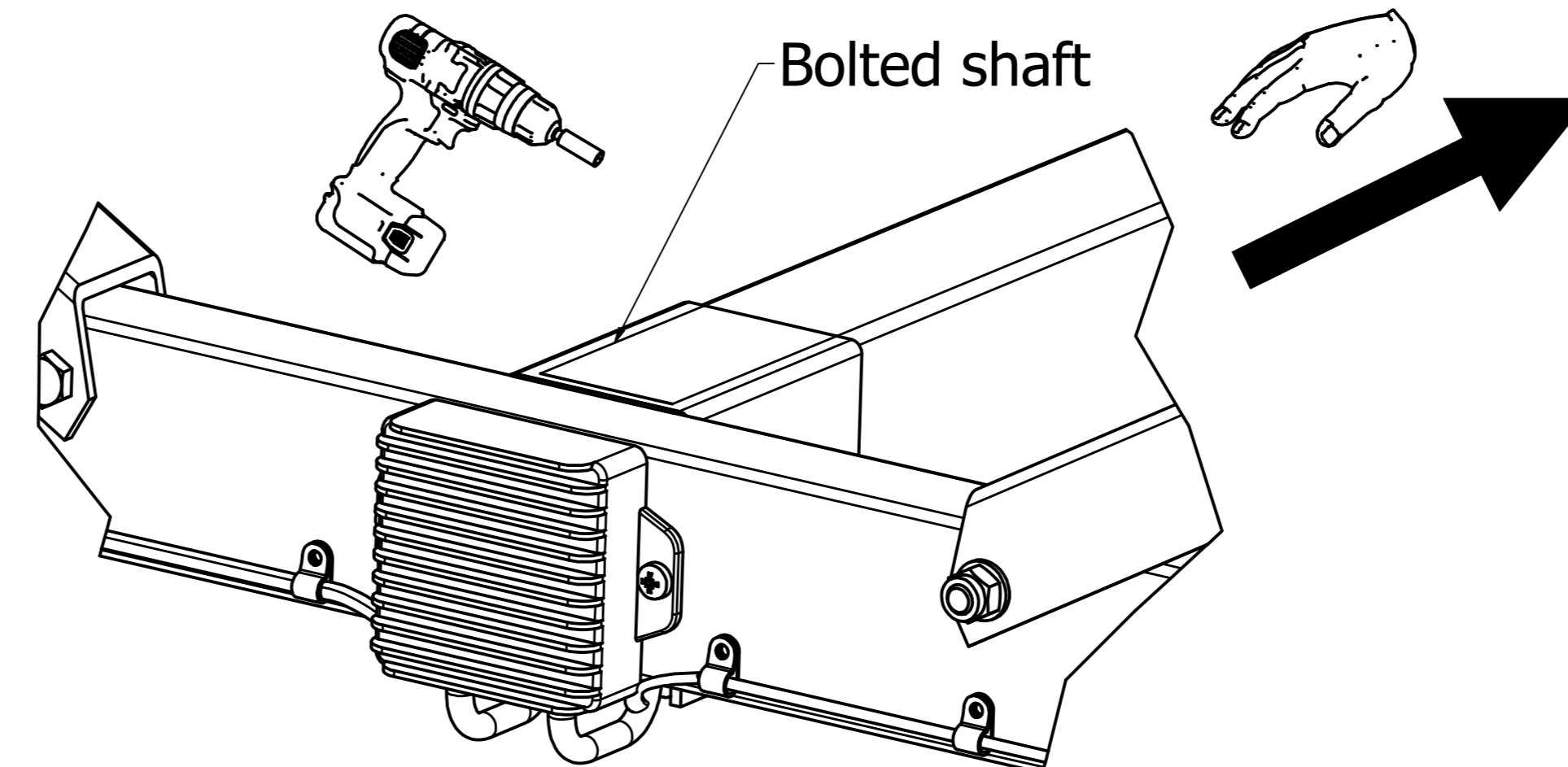

Created by	MM	Creation Date	21.09.2019	Total Pages	N/A	Form	A0	Scale	0,08 : 1	Sheet of Sheets	2 / 2	
												
Assembly instruction- Boat trailer												
Boat Trailers												
Part Number (Drawing)	NK									Drawing Number	IN109912	
											Rev.	A